

SWAGTRON® *E-BIKE*™

EB-1

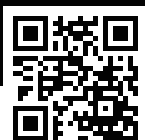

USER MANUAL

Thank you for your purchase of the EB-1 E-Bike by SWAGTRON®!

We are the original and official EB-1 E-Bike . There are many generic and copycat brands out there, but don't be fooled. If you want real swag, you're in the right place.

To ensure your safety and the safety of others, please read and be sure to follow all instructions and safety recommendations in this user manual prior to and when riding your bike.

If you have any questions regarding the SWAGTRON® EB-1 E-Bike, contact us at 1-844-299-0625 for further assistance.

Happy Riding!

-The SWAGTRON® Team

Table of Contents

PRODUCT SAFETY NOTICE	1
Section 1. General Information.....	3
1.1 About the SWAGTRON® EB-1 E-Bike.....	3
1.2 What's In the Box?	4
1.3 SWAGTRON® EB-1 E-Bike Diagram.....	5
Section 2. Assembling, Adjusting & Folding Your SWAGTRON® EB-1 E-Bike.....	6
2.1 Unfolding and Folding the Stem.....	6
2.2 Installing the Fenders	7
2.3 Attaching the Pedals.....	8
2.4 Unfolding & Folding the Pedals	8
2.5 Adjusting the Handlebars	9
2.6 Installing & Adjusting the Seat.....	9
Section 3. Charging Your SWAGTRON® EB-1 E-Bike.....	10
Section 4. How to Ride.....	12
Section 5. Safe Riding Techniques & Tips	13
5.1 Disposal at End-of-Life	14
Section 6. Maintenance	14
6.1 Cleaning.....	15
6.2 Storage.....	15
6.3 Transportation	15
Section 7. Specifications	16
1 Year Limited Hardware Warranty.....	17

PRODUCT SAFETY NOTICE

The SWAGTRON® EB-1 E-Bike has been designed with the utmost safety in mind for its riders. Extra precautions have been taken to protect the user from product hardware malfunctions through our meticulous design and engineering.

However, like any mode of transportation, the SWAGTRON® EB-1 E-Bike has inherent hazards associated with its use (e.g.: losing control, falling off, or riding into a hazardous situation). Please read and be sure to follow all instructions and safety recommendations in this user manual prior to and when riding your E-Bike.

Before each ride, especially if you may travel a long distance, inspect your bike. First, check the tires for proper inflation and cracks on the walls of the tires. Keeping the tires properly inflated and maintained will help prevent flats and damage. Second, check all cables and cable housings for fraying, breaks, rust, or corrosion and replace if necessary. Lastly, inspect the brakes to make sure they are working properly. Additionally, check the brake pads for any damage as they will wear over time and eventually need replacement.

If a replacement of the brake pads or any other part is needed, please contact customer support for replacement service. In general, it is recommended to make sure all nuts and bolts are taut and properly fastened to prevent injury and unnecessary wear and tear on your E-Bike.

Maximum Weight	242.5 lbs / 110kg
Maximum Speed	12.4 MPH / 20 km/h
Max Incline	25°

This device requires coordination, agility, and balance. Use your best judgement to determine if an individual can use the SWAGTRON® EB-1 E-Bike safely.

SAFETY GEAR, CLOTHING, AND FOOTWEAR	<p>Please wear appropriate clothing and safety gear including shoes, kneepads, elbow pads and an ASTM F1492 approved helmet.</p> <p>Avoid wearing anything that can drape over or get caught into/under the wheels. Wear closed-toe, flat shoes to maintain flexibility and stability.</p>
MODIFICATIONS AND REPAIRS	<p>The SWAGTRON® EB-1 E-Bike is a highly sophisticated electronics product that includes complex, technical circuitry. Attempting to repair or modify your E-Bike can void all warranties. Only authorized repair centers may open and service the SWAGTRON® EB-1 E-Bike.</p>
OBEY LOCAL LAWS AND REGULATIONS	<p>Always check and adhere to local laws regarding personal transportation devices, including pedestrian laws.</p> <p>The E-Bike is considered a motor vehicle, so should not be ridden after consumption of alcohol, drugs, or while intoxicated. You can be arrested for drunk driving.</p>

By riding the SWAGTRON® EB-1 E-Bike, the user acknowledges and accepts personal responsibility of all risks associated with the use of the SWAGTRON® EB-1 E-Bike, which may include, but are not limited to, muscle injuries, broken bones, lacerations, or serious injury which may be sustained while using the SWAGTRON® EB-1 E-Bike.

Section 1. General Information

This user manual will guide you through the functions and usage of your SWAGTRON® EB-1 E-Bike. Before operating this device, read all the instructions for safe assembly, charging, and usage.

Upon unpacking, please inspect the SWAGTRON® EB-1 E-Bike for any signs of physical damage or defects. Ensure that the SWAGTRON® EB-1 E-Bike is fully charged before using.

If you have questions, contact SWAGTRON® before you attempt to use or return your E-Bike.

1.1 About the SWAGTRON® EB-1 E-Bike

The EB-1 Folding Electric Bike by SWAGTRON® is a compact, zero emissions personal transportation device that feels like a scooter but rides like a motorcycle. It's environmentally-friendly and uses only the highest quality components and industry-leading safety features.

- Riding speeds up to 12.4 mph
- Rechargeable, portable, and reliable
- Eco-friendly and all-electric with zero emissions



1.2 What's In the Box?

- 1 x SWAGTRON® EB-1 E-Bike
- 2 x Fenders
- 1 x Charging Cable & Adapter
- 1 x Allen Key
- 1 x Seat
- 2 x Pedals
- 2 x Bolts*
- 1 x Wrench
- 1 x User Manual

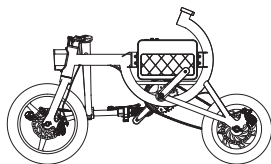

SWAGTRON® EB-1 E-Bike x 1



Fenders x 2



Charging Cable & Adapter x 1



Allen Key x 1



Seat x 1



Pedals x 2

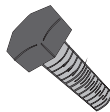

Bolts x 2



Wrench x 1



User Manual x 1

* Bolts and nuts may already be connected to the fenders.

1.3 SWAGTRON® EB-1 E-Bike Diagram

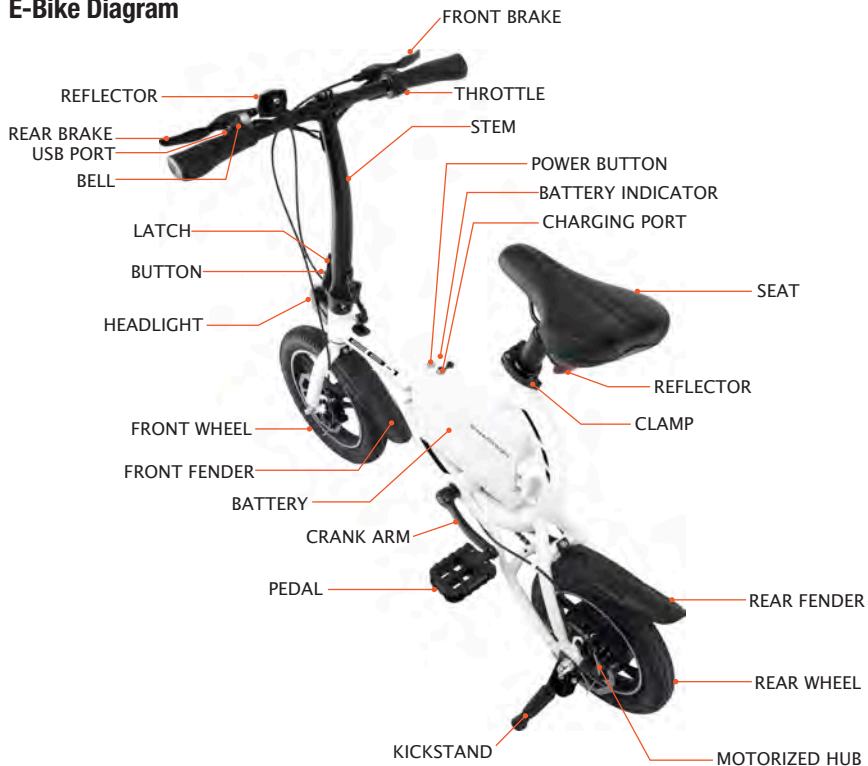

Section 2. Assembling, Adjusting & Folding Your SWAGTRON® EB-1 E-Bike

WARNING: Be careful not to position your fingers between the latch and the frame. Doing so may result in injury.

2.1 Unfolding and Folding the Stem

To Unfold

Step 1. Pull the stem and handlebars upright (fig.1)

Step 2. Fold the latch up to close it. It will snap into place (fig.2).

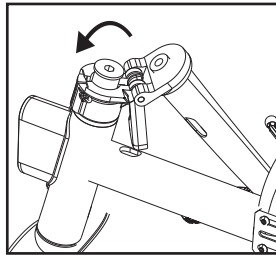

fig.1

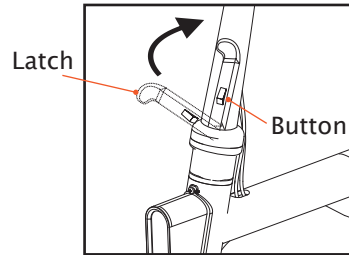

fig.2

To Fold

Step 1. Press the button and pull the latch down away from the stem (fig.3).

Step 2. With the latch undone, fold the stem down. (fig.4).

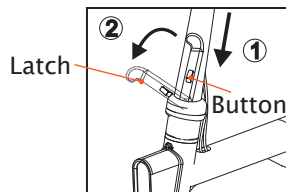

fig.3

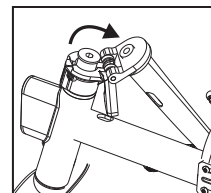

fig.4

2.2 Installing the Fenders



Bolts and nuts may already be connected to the fenders. Unscrew each bolt and nut from each fender before installation.

Attach the two fenders over the front and rear wheels using the included bolts, nuts, and Allen key. A pair of pliers will also be needed. Use pliers to hold the nut while using the Allen key to tighten the bolts (fig.5-6).

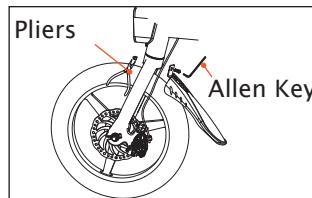

fig.5

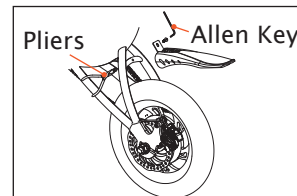

fig.6



The longest bolt **MUST** be used to install the front fender while the shorter bolt should be used to install the rear fender.

2.3 Attaching the Pedals

Before installing the pedals, please check each for a small letter to indicate which side of the bike the pedal should be attached to. **L** is for the left side while **R** is for the right side (fig.7).

With the kickstand holding your E-Bike upright, screw the pedals onto the crank arms (fig.8) and tighten them with the included wrench.



fig.7

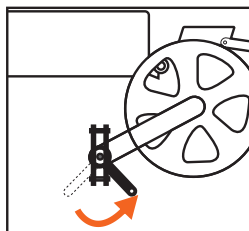

fig.8

2.4 Unfolding & Folding the Pedals

Holding the crank arm vertical, fold or unfold the pedal. Repeat with the other pedal as needed (fig.9).

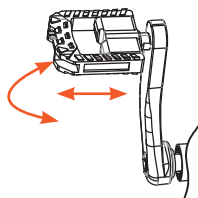

fig.9

2.5 Adjusting the Handlebars

Unfold the clamp to rotate and adjust the direction of the handlebars to a comfortable position. Secure the handlebars by flipping the clamp closed (fig.10).

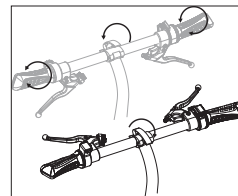

fig.10

2.6 Installing & Adjusting the Seat

For better pedaling, safety, and overall comfort, positioning the seat at the right height is key. The rider's leg length is used to determine the seat's position. During pedaling, your hips should remain level while your legs shouldn't suffer strain from over-extension. To determine the right seat height, sit on the E-Bike with one pedal at its lowest point and place the ball of your foot on the pedal. If your knee bends slightly at this position, the seat is at the right height. Additionally, when placing your heel on the pedal, your leg should be nearly straight.

Step 1. Open the clamp under the seat post, and position the seat post over the stem to press it onto the stem (fig.11).

Step 2. Pull the seat up or push it down to adjust height. Check to make sure the seat post is fully inserted into the frame and the head of the seat is parallel with the frame. then close the clamp to secure the seat in place (fig. 12).

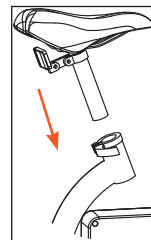

fig.11

Note: The nuts may loosen over time. For your safety, periodically make sure all nuts and bolts are taut and properly fastened.

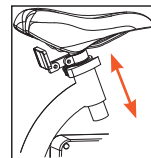

fig.12

Section 3. Charging Your SWAGTRON® EB-1 E-Bike

WARNING: Ensure the E-Bike is turned off before charging and remains off while charging.

Step 1. Connect the charging adapter and cable together then remove the rubber cap covering the bike's charging port (fig.13).

Step 2. Insert one end of the charging cable into the charging port and connect the other end to a wall outlet (fig.14).

Step 3. Allow at least 3 hours when charging for the first time. After this initial charge, average charging time is 2-3 hours.

Step 4. While the E-Bike is charging, the adapter's indicator light will turn red.

Step 5. When the E-Bike is fully recharged, the adapter's indicator light will turn green. You may then disconnect the E-Bike from the charger.

Indicator Lights

The four indicator's lights are near the charging port. After your bike is powered on, you can check the indicator lights for battery life.

No. of Lights	Battery Status
1 light	1%-25%
2 lights	25%-50%
3 lights	50%-75%
4 lights	75%-100%

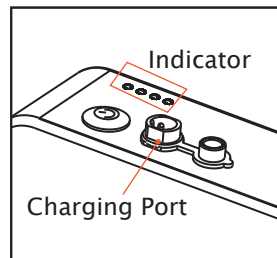

fig.13

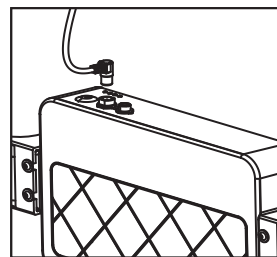

fig.14

Safety tips for charging your battery:

- Fully charge the battery before your first use, this may take up to 3 hours.
- To maximize the life of the battery, you must charge it after each riding session.
- When not in active use, please charge at least once a month to maintain optimal battery levels.
- Perform periodic visual inspection of the battery ports and charger cables.

NOTE:

- When the battery is fully charged, please STOP CHARGING and unplug the unit.
- Keep your charging environment clean and dry at all times.
- If the charging port is damp or has any liquid on it, do not charge your E-Bike.
- In order for the battery to operate at maximum efficiency, avoid charging your E-Bike in extremely hot or extremely cold environments.
- Use only the battery and charging cable provided to you by SWAGTRON®, use of third party products may compromise the battery and damage the E-Bike. If a replacement is needed, please contact SWAGTRON® directly.

DO NOT charge the battery in the following cases:

- There is excessive odor or heat.
- Leakage or physical damage.

Section 4. How to Ride

The instructions below will ensure you have a comfortable and safe riding experience. Please read carefully.

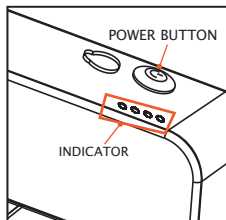



fig.15



fig.16

- Start your E-Bike by pressing the Power Button, or ride it with your feet directly (fig.15).
 - Moving forward on your E-Bike is as easy as pushing the Throttle (fig.16).
 - To slow down, first let go of the Throttle then gradually squeeze the Rear Brake to slow the rear motorized wheel down (fig.16).
 - To stop, first let go of the Throttle, then squeeze the front and rear brakes to slow the front and rear wheels down (fig.16).
 - Use the Bell to alert pedestrians and other riders of your presence (fig.16).
 - The Indicator lights show how much charge is left in the battery. Make sure the battery is at full power before heading out on a long distance ride (fig.15).
-  The Headlight automatically turns on/off when the E-Bike is powered on/off. It adjusts according to light from the surrounding environment i.e. in strong light, the headlight may turn off while in low light, the headlight will turn on.

Section 5. Safe Riding Techniques & Tips

Following these techniques and tips can ensure you have a safe, fun riding experience on the EB-1E-Bike. Check to make sure your brakes are fully intact, Pedals are securely installed, and handlebars are locked in place.

- Always wear an ASTM F1492 approved helmet and protective gear to avoid possible injury.
- Make sure your feet are always on the Pedals. Taking your feet off the pegs while riding is dangerous.
- Ensure the battery is fully charged especially if you plan to travel long distances.
- Ensure your tires are intact with no punctures.
- Ensure the vehicle speed is safe to yourself and others, and be ready to stop at any time.
- When riding with friends, keep a safe distance between your devices to prevent collisions.
- Be aware of your surroundings at all times to ensure a safe ride. Your eyes are your best tools for safely avoiding obstacles and slippery surfaces.
- Stay in open spaces and flat areas, avoid steep slopes or high traffic areas until you're familiar with riding.
- The E-Bike can only support the weight of one person at a time.
- Only ride the E-Bike where permitted, you **MUST** comply with local laws and give way to pedestrians.

WARNING:

- Never ride at high speeds on uneven terrain or slopes.
- Never perform stunts or turn abruptly without checking your surroundings.
- Never carry passengers on the E-Bike with you.
- Never carry heavy items while riding.
- Never ride in the rain.
- Never use the E-Bike to do anything that may cause personal injury or property damage.
- Never get off the E-Bike when it is in motion.

FAILURE TO USE COMMON SENSE AND HEED THE ABOVE WARNINGS INCREASES THE RISK OF SERIOUS INJURY, OR IN VERY RARE CASES, DEATH. USE WITH APPROPRIATE CAUTION AND SERIOUS ATTENTION TO SAFE OPERATION.

For more safe riding tips or information, visit www.swagtron.com.

5.1 Disposal at End-of-Life

This product must not be disposed of by incineration, landfilling, or mixing with household trash. Improper disposal of the battery contained within this product may result in the battery heating up, rupturing, or igniting which may cause serious injury. The substances contained inside the battery present chemical risks to the environment. The recommended disposal for any SWAGTRON® product at its end-of-life is to dispose of the entire unit at or through an e-waste recycling center, program, or facility. Local regulations and laws pertaining to the recycling and disposal of lithium-ion batteries and/or products containing them will vary according to country, state, and local governments. You must check laws and regulations corresponding to where you live in order to properly dispose of the battery and/or unit. It is the user's responsibility to dispose of their waste equipment properly with accordance with local regulations and laws.

For additional information about where you should drop off your batteries and electrical or electronic waste, please contact your local or regional waste-management office, your household waste disposal service, or your point-of-sale.

Section 6. Maintenance

Follow the tips and reminders below to keep your E-Bike running at top performance.

NOTE:

- Do not perform any kind of maintenance while the E-Bike is charging.
- Attempting to repair or modify your E-Bike can void all warranties, only authorized repair centers may open and service the E-Bike.

If you need assistance, please contact SWAGTRON® support at support@swagtron.com.

6.1 Cleaning

Proper cleaning of your E-Bike can guarantee a longer lifespan and a smooth riding experience.

- Wipe the outer body of your E-Bike with a soft, dry microfiber cloth.
- Check around the wheels and ensure there is no blockage, the E-Bike's design allows for easy wheel maintenance.
- The E-Bike meets IP44 dust and water resistance, meaning it can withstand splashes, however, do not submerge the E-Bike in water.
- Do not let water and liquids get into the E-Bike's electric parts or battery.

6.2 Storage

Below are some tips to consider when storing your SWAGTRON® EB-1 E-Bike.

- Before storing, fully charge the E-Bike to prevent battery over-discharge due to non-use.
- If storing the E-Bike for more than one month, discharge and recharge the battery at least once a month.
- Cover the E-Bike to keep dust out. Do not store in a dusty environment as this may cause damage over time.

6.3 Transportation

Before moving, lifting, or otherwise transporting the E-Bike, turn it off. Fold the E-Bike and grasp it firmly before lifting and/or moving it. Note, the E-Bike weighs approximately 38.4 lbs. If you are unsure of your ability to lift this much weight with one hand or arm, doing so is not recommended. Please lift the E-Bike with both arms or otherwise gain the assistance of someone who may handle the weight without trouble.

Lithium-ion batteries are considered hazardous materials, therefore transportation is governed by federal, state, and local laws.

International law prohibits the shipping of bare lithium-ion batteries. If you are shipping your SWAGTRON® EB-1 E-Bike, you must ship it with the battery installed.

Section 7. Specifications

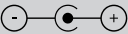
Item	Parameters
Net Weight	38.4 lbs / 17.4 kg
Dimensions (Open Size)	44.9 x 37.4 x 22.1 in. / 1140 x 950 x 560 mm.
Dimensions (Folding Size)	44.9 x 26.2 x 10.2 in. / 1140 x 665 x 260 mm.
Max Incline	25°
Maximum Load	242.5 lbs / 110 kg
Battery	36V 4.4 Ah
Charging Voltage	AC 100V-240V / 50 - 60Hz DC 42V 2A 
Charging Time	2~3 Hours
Wheel Size	Front Wheel 14 in./Rear Wheel 12 in.
Wheel Inflation	Front Wheel: PSI 40-65 2.8-4.5 BAR Rear Wheel:40 PSI 2.8 BAR
Water Resistance	IP44
Warranty	1 Year Limited

1 Year Limited Hardware Warranty

Your SWAGTRON® EB-1 E-Bike ("Product") includes a One Year Limited Hardware Warranty ("Warranty"). The Warranty covers product defects in materials and workmanship under normal use. This Warranty is limited to residents of the United States and Canada only and is available only to original purchasers. This Warranty gives you specific legal rights and you may also have other rights which vary from state to state.

This Warranty starts on the date of your purchase and lasts for one year (the "Warranty Period"). The Warranty Period is not extended if the Product is repaired or replaced. We may change the availability of this limited warranty at our discretion, but any changes will not be retroactive.

Warranty services are provided by SWAGTRON®. If a hardware defect arises and a valid claim is received within the Warranty Period, at its option and to the extent permitted by law, SWAGTRON® will: (1) repair the hardware defect by using new or refurbished parts that are equivalent to new in performance and reliability; or (2) exchange the Product with a product that is new or refurbished which is substantially equivalent to the original product. This Warranty is for one replacement only of like-items and does not cover items out of production if the product is no longer made or stocked. This Warranty is not assignable or transferable. The original purchaser may call SWAGTRON's toll-free number at 1-844-299-0625 for service request.

When a product or part is exchanged, any replacement item becomes your property and the replaced item becomes SWAGTRON's property. This warranty only covers technical hardware defectiveness during the warranty period and under normal use conditions. SWAGTRON® does not warrant uninterrupted or error-free operation of this Product.

This Warranty does not cover any damage due to: (a) transportation; (b) storage; (c) improper use; (d) failure to follow the product instructions or to perform any preventive maintenance; (e) modifications; (f) unauthorized repair; (g) normal wear and tear; or (h) external causes such as accidents, abuse, or other actions or events beyond our reasonable control.

Important: Do not disassemble the Product. Disassembling the Product will void this Warranty. Only SWAGTRON® or a party expressly authorized by SWAGTRON® should perform service on this Product.

DISCLAIMER OF WARRANTY: THE REMEDIES DESCRIBED ABOVE ARE YOUR SOLE AND EXCLUSIVE REMEDIES AND OUR ENTIRE LIABILITY FOR ANY BREACH OF THIS LIMITED WARRANTY. OUR LIABILITY SHALL UNDER NO CIRCUMSTANCES EXCEED THE ACTUAL AMOUNT PAID BY YOU FOR THE DEFECTIVE PRODUCT, NOR SHALL WE UNDER ANY CIRCUMSTANCES BE LIABLE FOR ANY CONSEQUENTIAL, INCIDENTAL, SPECIAL OR PUNITIVE DAMAGES OR LOSSES, WHETHER DIRECT OR INDIRECT.

SOME STATES DO NOT ALLOW THE EXCLUSION OR LIMITATION OF INCIDENTAL OR CONSEQUENTIAL DAMAGES, SO THE ABOVE LIMITATION OR EXCLUSION MAY NOT APPLY TO YOU.

THE DURATION AND REMEDIES OF ALL IMPLIED WARRANTIES, INCLUDING WITHOUT LIMITATION THE WARRANTIES OF MERCHANTABILITY AND FITNESS FOR A PARTICULAR PURPOSE ARE LIMITED TO THE DURATION OF THIS EXPRESS LIMITED WARRANTY.

SWAGTRON®

COPYRIGHT © 2018 SWAGTRON. ALL RIGHTS RESERVED.